

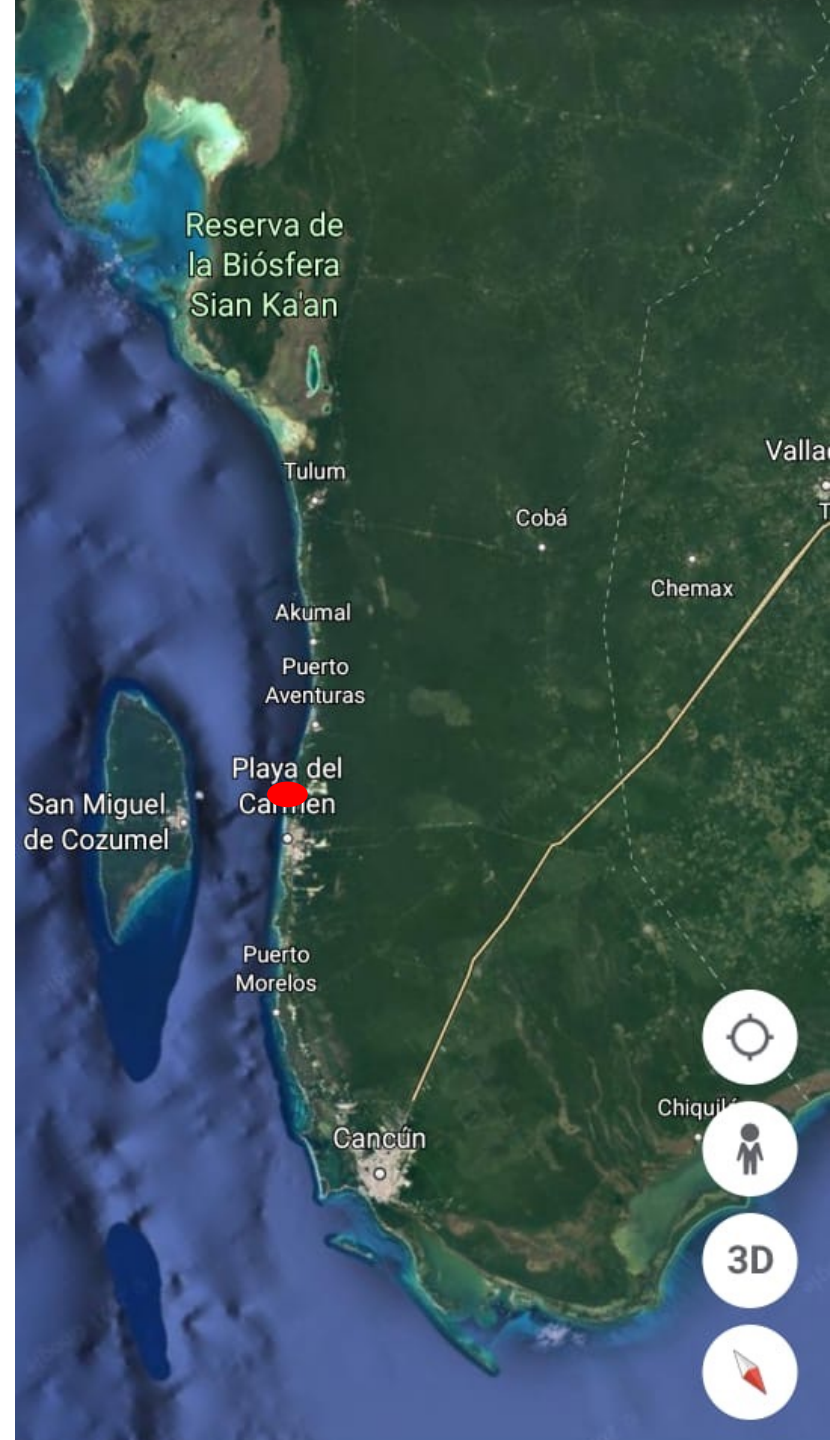

ARQUITECTURA MIXTA

A large, curved, woven bamboo structure, possibly a roof or a large-scale architectural installation. The structure is composed of numerous thin bamboo poles woven together to form a dense, textured surface. The structure is curved, creating a sense of depth and movement. Several large, tree-like columns are integrated into the structure, each with a thick, woven trunk and a wide, flat, circular canopy. The columns are positioned at intervals along the curve. The overall color is a warm, golden-brown, characteristic of bamboo. The background shows a clear blue sky with some light clouds. The ground is sandy and appears to be outdoors. The text "GUARDIANS" is written in a bold, black, serif font in the upper right quadrant of the image.

GUARDIANS



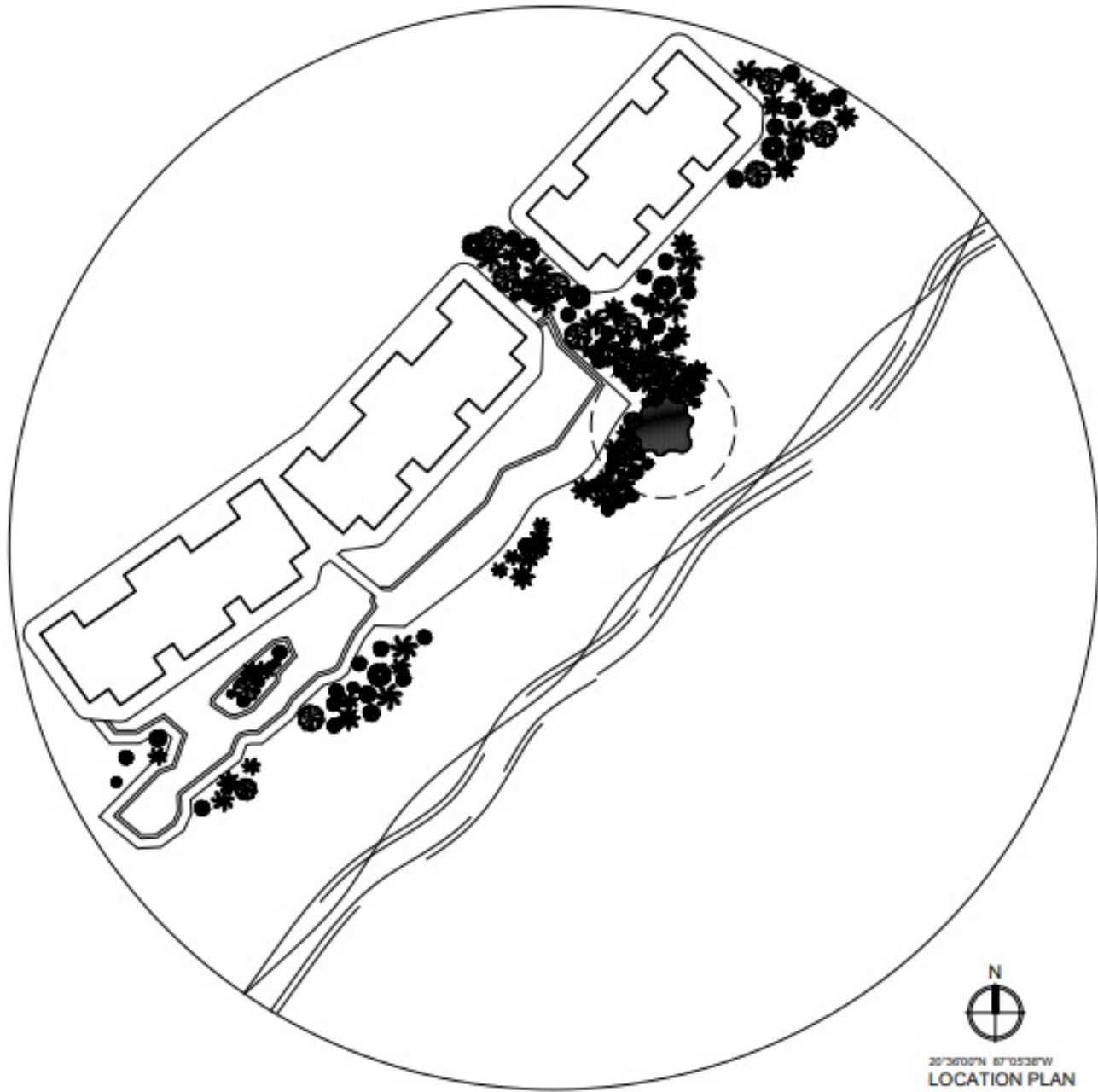

20°26'00"N 87°05'30"W
LOCATION PLAN

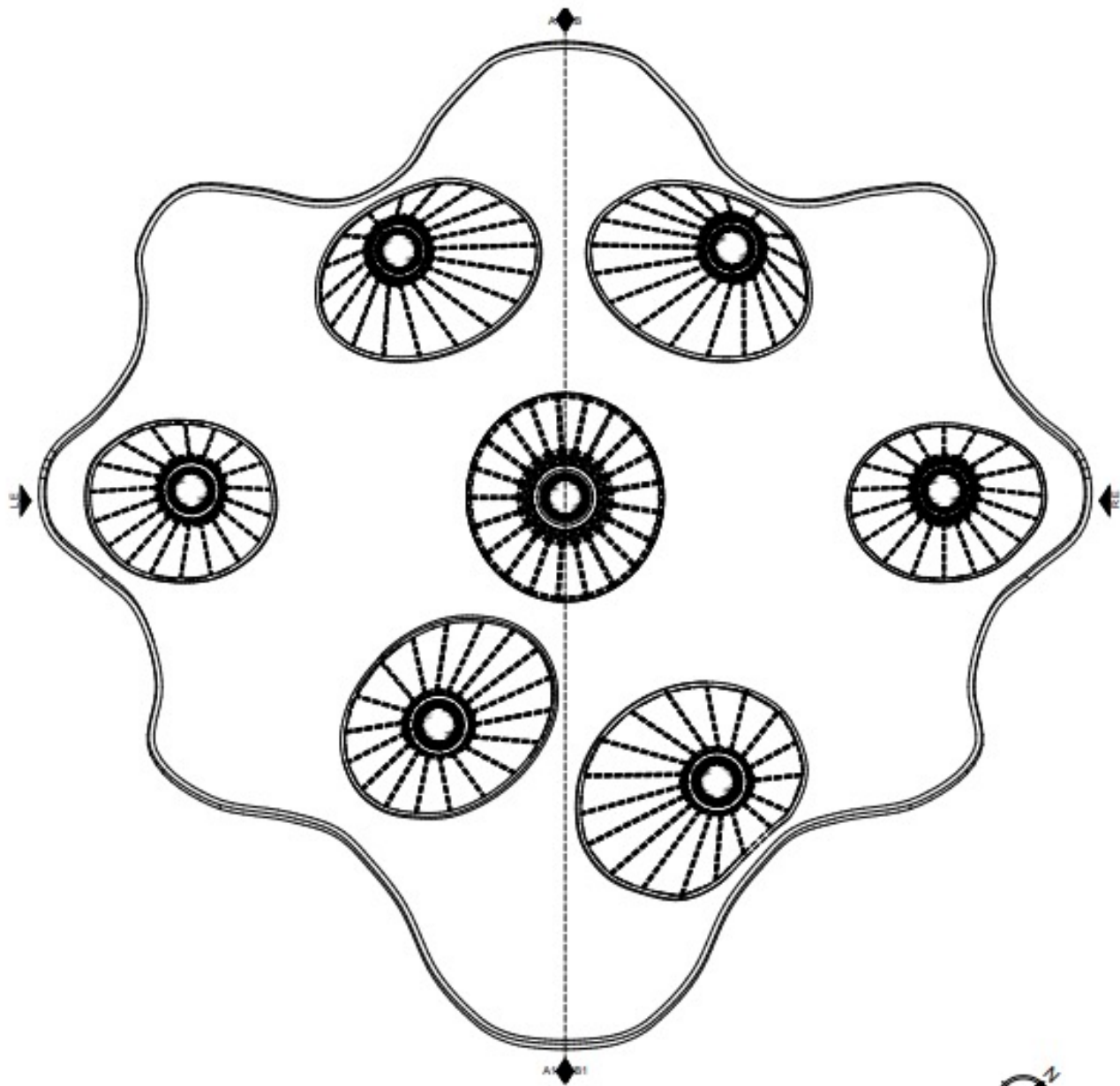

FLOOR PLAN





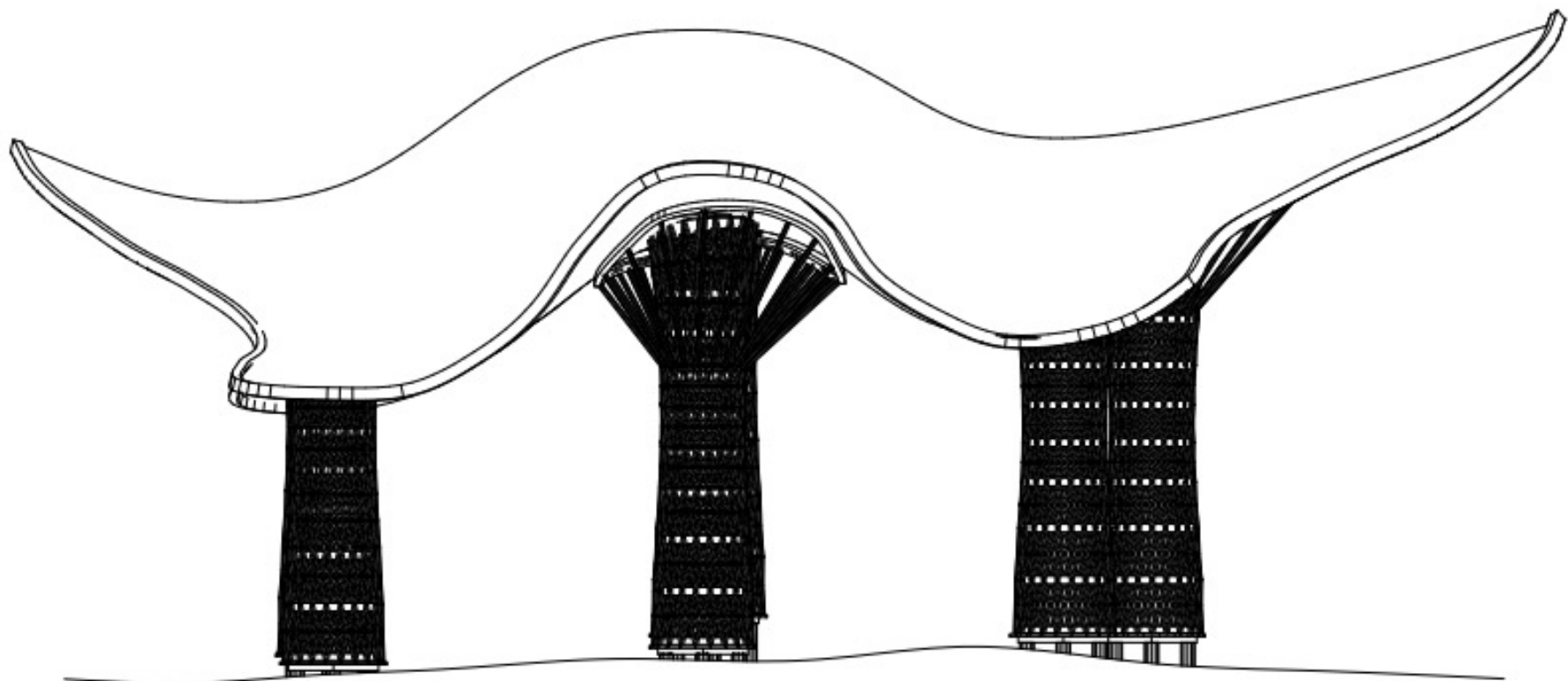

LEFT ELEVATION

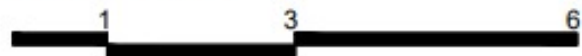

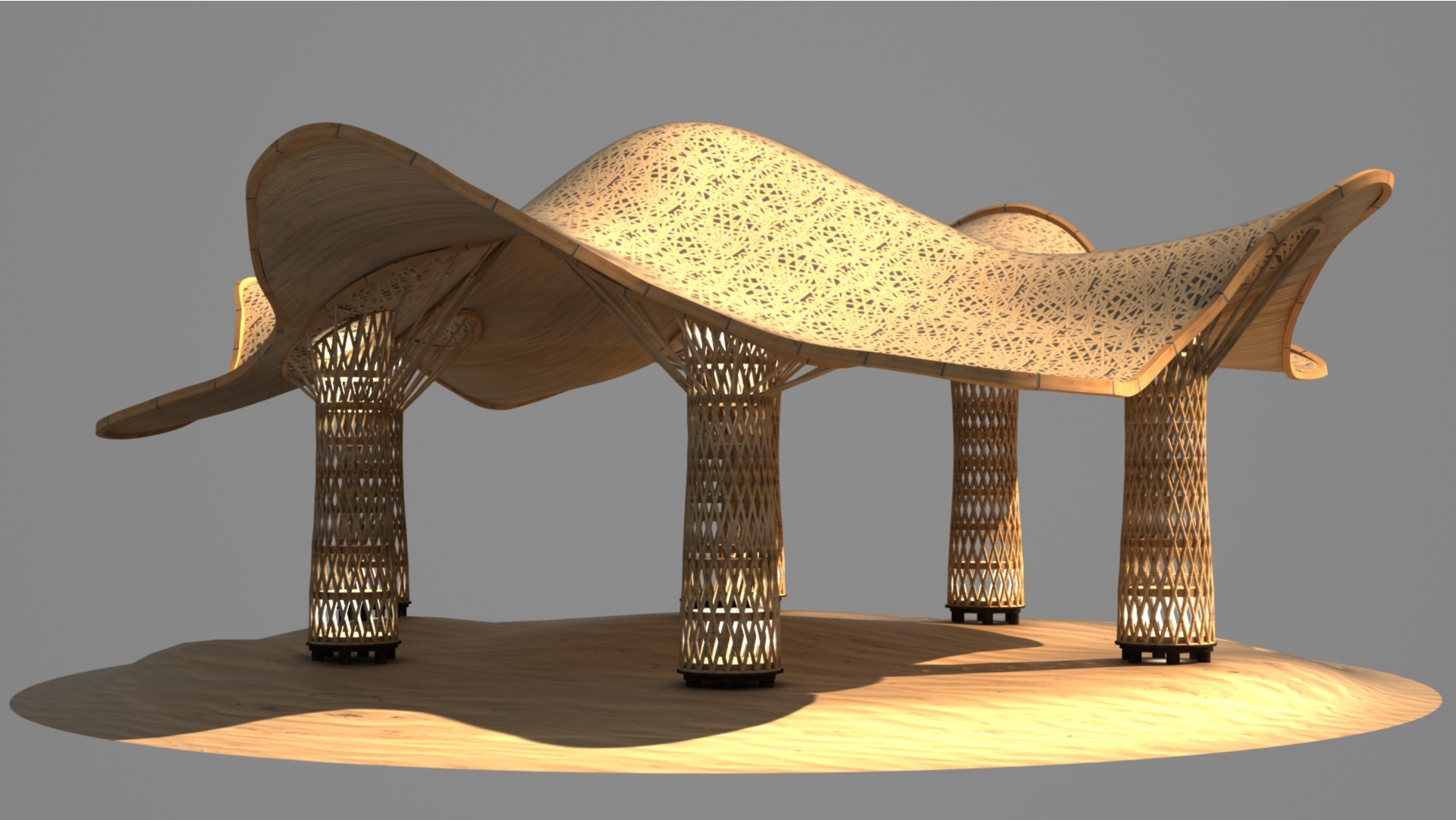

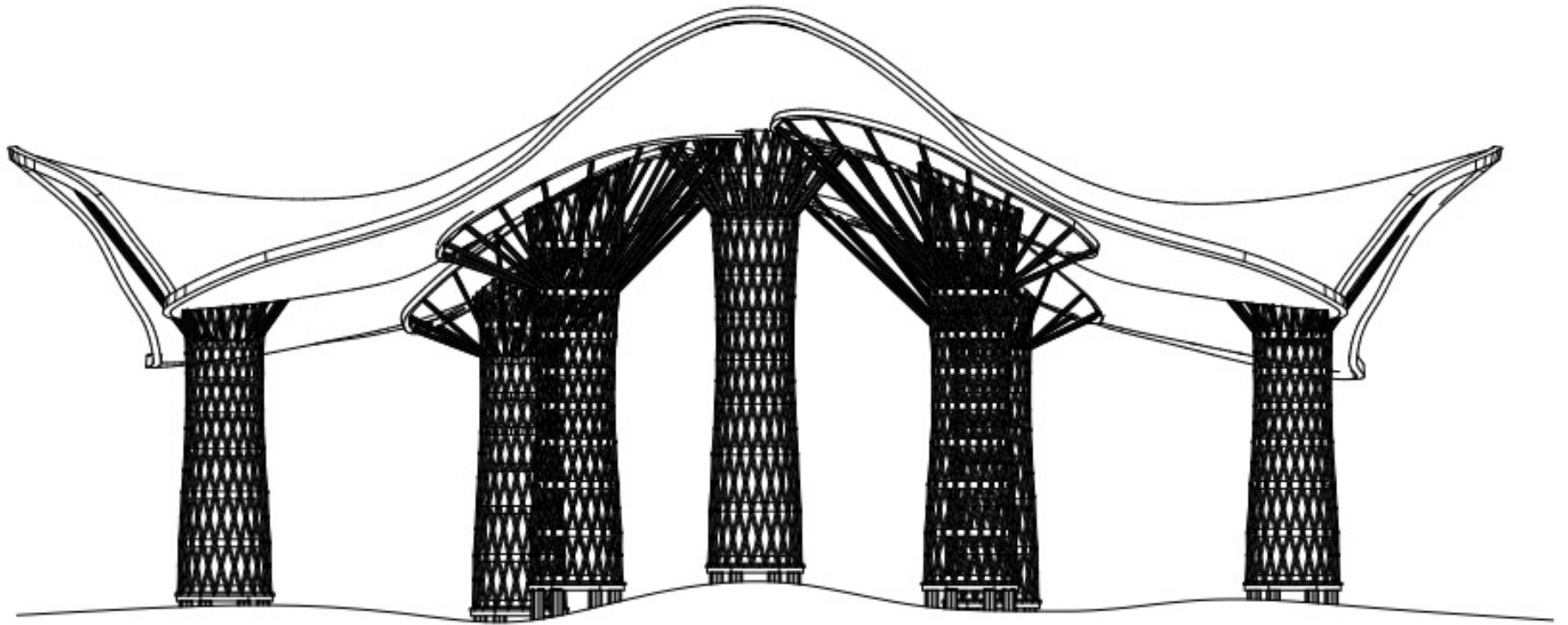

FRONTAL ELEVATION













Reglillas de Bambú *Guadua angustifolia*







bambumaya
Palenque, Chiapas, Mexico

































Branching in Biology

Branching– an efficient way to distribute and collect materials and energy in biological systems

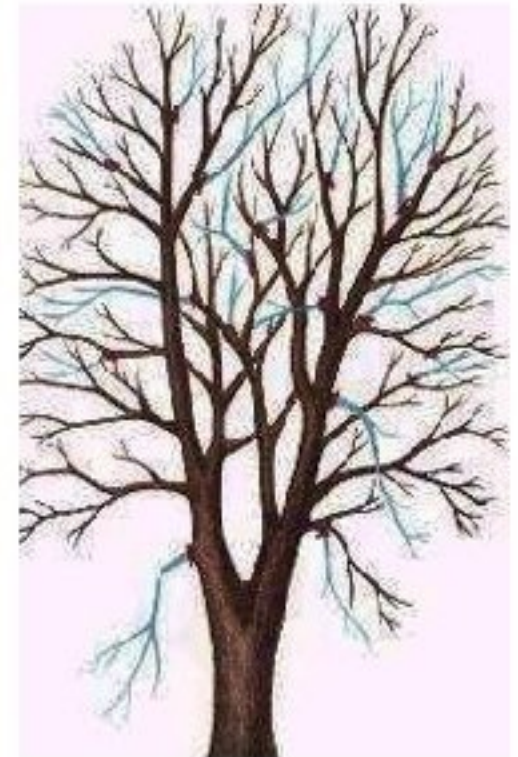



The mycelium is the part of the mushroom you usually do not see. Most of it is found distributed throughout the soil, consisting of a mass of branching, thread-like structures (known as hyphae) which absorb nutrients and decompose organic materials. The mycelium can be exceedingly small or may form a colony of massive proportions.



























A large, curved, woven bamboo structure, possibly a canopy or a large-scale architectural installation. The structure is composed of numerous thin bamboo poles woven together to form a dense, textured surface. The structure is curved, creating a sense of depth and enclosure. Several tree-like columns are integrated into the structure, each with a thick, woven trunk and a wide, flat, circular top that resembles a tree canopy. The columns are positioned at intervals along the curve. On the left side, there is a vertical wall made of a lattice of bamboo poles. The structure is set against a background of a clear blue sky with some light clouds. The overall aesthetic is natural and organic, emphasizing the use of bamboo as a sustainable building material.

THANKS

